

Glass Systems B125 Adjustable Discs



Product Features

- Manufactured from 316 grade Stainless Steel for a long service life.
- Fully adjustable for ease of installation, Fast Fix Anchors don't need to be packed out with washers to attain correct glass alignment.
- Additionally if required in the future through movement of timber, they can be easily adjusted to re-align glass panels without removing the glass.
- The unique base allows for ease of installation when fixing to concrete, steel or timber, without fixings needing to be mm perfect.
- Available in Face Fix or Concealed Fixed options to match customer design requirements.



Glass Systems B125 Adjustable Discs

Concealed Fixed Disc

Product Code	Description
D50PS	Concealed Fix Disc 50mm
D50SS	Concealed Fix Disc 50mm

Finish

PS
SS

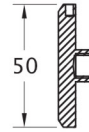
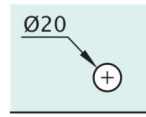

Face Fixed Disc

Product Code	Description
D52PS	Face Fix Disc 50mm
D52SS	Face Fix Disc 50mm

Finish

PS
SS

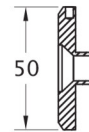
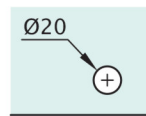

Spacer Kit

Product Code	Description
D51PS	Fast Fix Spacer 50×30mm
D51SS	Fast Fix Spacer 50×30mm

Finish

PS
SS

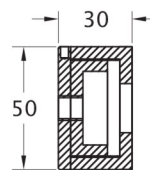

Complete Sets

Face Fix Set	Concealed Fix Set
Code A10PS	Code A20PS
A10SS	A20SS



Spacer Adjustment

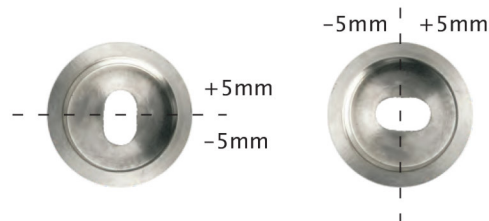

wind spacer body
out to align glass
½ a turn = approx
10mm movement
at top of glass

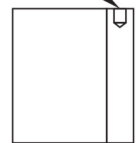

Glass Adjustment / Fixing Options

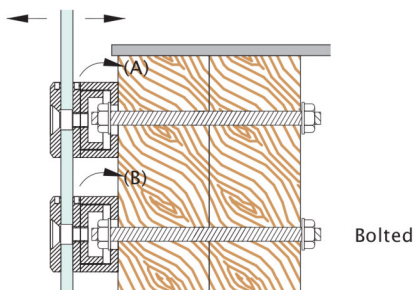

Bolted

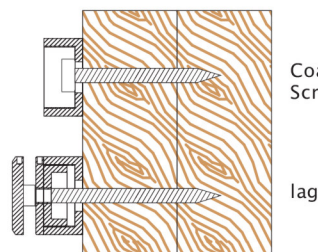

Coach
Screw

lag

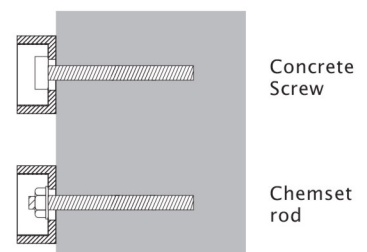

Concrete
Screw

Chemset
rod

Note

- Turn A Anti clockwise Plumbs Glass to outside.
- Turn B Anti clockwise Plumbs Glass to inside.